

**Ersatzteilverzeichnis P50/94-110D 105°C**  
**Spare Parts List P50/94-110DK 105°C**

**Best.-Nr.: 00.2642**  
**Code Nr. 00.3806**

| Lfd. Nr.<br>Item No. | Stückzahl<br>No. Off | Best.-Nr.<br>Code No. | Benennung                         | Description                       |
|----------------------|----------------------|-----------------------|-----------------------------------|-----------------------------------|
| 1                    | 1                    | 01.0608               | Antriebsgehäuse (P50/94-110D)     | Crankcase (P50/94-110D)           |
| 1                    | 1                    | 01.0377               | Antriebsgehäuse (P50/94-110DK)    | Crankcase (P50/94-110DK)          |
| 2                    | 1                    | 00.2914               | Ölauffüllstopfen kpl.             | Oil Filler Plug Assy              |
| 3                    | 1                    | 03.0364               | Abdeckblech                       | Cover Plate                       |
| 3A                   | 2                    | 07.3052               | Federring                         | Spring Ring                       |
| 3B                   | 2                    | 21.0290               | Sechskantschraube                 | Hexagon Screw                     |
| 4                    | 1                    | 03.0274               | Getriebedeckel                    | Crankcase Cover                   |
| 5                    | 1                    | 06.0103               | O-Ring zu 4                       | O-Ring for 4                      |
| 6                    | 1                    | 00.2416               | Ölschauglas kpl.                  | Oil Sight Glass Assy              |
| 8                    | 1                    | 00.4502               | Ölmeßstab kpl.                    | Oil Dipstick Assy                 |
| 9                    | 1                    | 06.0053               | O-Ring zu 8                       | O-Ring for 8                      |
| 10                   | 4                    | 21.0026               | Zylinderschraube                  | Cylinder Screw                    |
| 11                   | 5                    | 07.2994               | Federring                         | Spring Ring                       |
| 12                   | 1                    | 07.0705               | Stopfen G1/2                      | Plug G1/2                         |
| 13                   | 1                    | 06.0282               | Dichtung                          | Gasket                            |
| 14                   | 2                    | 03.0137               | Lagerdeckel                       | Bearing Cover                     |
| 15                   | 2                    | 06.0101               | Radialwellendichtring             | Radial Shaft Seal                 |
| 16                   | 2                    | 06.0104               | O-Ring                            | O-Ring                            |
| 17                   | 8                    | 21.0034               | Sechskantkombischraube            | Hexagon Screw                     |
| 20                   | 2                    | 05.0096               | Kegelrollenlager                  | Taper Roller Bearing              |
| 20A                  | 2                    | 07.0789               | Paßscheibe                        | Fitting Disc                      |
| 20B                  | 3                    | 07.2844               | Paßscheibe                        | Fitting Disc                      |
| 21                   | 1                    | 07.4563               | Wellenschutz                      | Shaft Protector                   |
| 21A                  | 1                    | 07.4687               | Wellenschutzhalter                | Shaft Guard Holder                |
| 22                   | 1                    | 11.0746               | Kurbelwelle                       | Crankshaft                        |
| 23                   | 1                    | 07.0671               | Scheibenfeder                     | Woodruff Key                      |
| 24                   | 3                    | 00.4391               | Gleitlagerpleuel kpl.             | Connecting Rod Assy               |
| 25                   | 3                    | 00.4392               | Kreuzkopf kpl.                    | Crosshead Assy                    |
| 28                   | 3                    | 11.0659               | Kreuzkopfbolzen                   | Crosshead Pin                     |
| 29A                  | 3                    | 07.0745               | Zentrierhülse                     | Seal Retainer                     |
| 29B                  | 3                    | 11.0243               | Plungerrohr                       | Plunger Pipe                      |
| 29C                  | 3                    | 07.0744               | Spannschraube                     | Tensioning Screw                  |
| 29D                  | 3                    | 06.0467               | Cu-Dichtring                      | Copper Ring                       |
| 30                   | 3                    | 07.3095               | Olablestreifer                    | Flinger                           |
| 31                   | 3                    | 00.1895               | Dichtungsaufnahme kpl. (31A-33)   | Seal Retainer (31A-33)            |
| •31A                 | 3                    | 06.0826               | Radialwellendichtring             | Radial Shaft Seal                 |
| 32                   | 3                    | 07.2138               | Dichtungsaufnahme                 | Retainer                          |
| •32A                 | 3                    | 06.0769               | O-Ring                            | O-Ring                            |
| •33                  | 3                    | 06.0097               | Compactring                       | Compact Ring                      |
| 35                   | 3                    | 07.0677               | Dichtungshülse (P50/94-110D)      | Seal Sleeve (P50/94-110D)         |
| 35                   | 3                    | 07.2948               | Dichtungshülse (P50/94-110DK)     | Seal Sleeve (P50/94-110DK)        |
| •36                  | 3                    | 06.0231               | Leckagedichtung                   | Leakage Seal                      |
| 37                   | 3                    | 07.0684               | Dichtungskassette                 | Seal Case                         |
| •38                  | 6                    | 06.0106               | O-Ring                            | O-Ring                            |
| 39                   | 3                    | 07.0756               | Druckring                         | Pressure Ring                     |
| •40                  | 6                    | 06.1075               | Manschette                        | Sleeve                            |
| 41                   | 3                    | 07.0755               | Stützring                         | Support Ring                      |
| 42                   | 3                    | 07.0766               | Spannfeder                        | Tension Spring                    |
| 43                   | 1                    | 01.0211               | Ventilgehäuse                     | Valve Casing                      |
| ••44A                | 9                    | 06.0107               | O-Ring                            | O-Ring                            |
| ••44B                | 3                    | 06.1321               | Stützring                         | Support Ring                      |
| 45                   | 3                    | 07.3464               | Feder                             | Spring                            |
| ••46A                | 6                    | 07.2456               | Ventilsitz                        | Valve Seat                        |
| ••46B                | 6                    | 07.2482               | Ventilplatte                      | Valve Plate                       |
| ••46C                | 6                    | 07.2473               | Ventilfeder                       | Valve Spring                      |
| ••46D                | 6                    | 07.2511               | Abstandsrohr                      | Spacer Pipe                       |
| 48                   | 3                    | 07.3166               | Stopfen M42x1.5                   | Plug M42x1.5                      |
| 49                   | 8                    | 21.0273               | Stiftschraube                     | Stud Bolt                         |
| 49A                  | 8                    | 07.0988               | Sechskantmutter                   | Hexagon Nut                       |
| 49B                  | 8                    | 07.2707               | Scheibe                           | Disc                              |
| 50                   | 1                    | 07.1000               | Stopfen G1/4                      | Stopfen G1/4                      |
| 50A                  | 1                    | 06.0108               | Cu-Dichtring                      | Copper Ring                       |
| 52                   | 1                    | 07.0796               | Scheibe für Kurbelwelle           | Disc for Crankshaft               |
| 53                   | 1                    | 21.0259               | Sechskantschraube                 | Hexagon Screw                     |
| 56                   | 3                    | 07.2397               | Einschrauber (P50/94-110DK)       | Threaded Pipe (P50/94-110DK)      |
| 57                   | 6                    | 07.2949               | Ermeto Gerade Einschr. (P50/94DK) | Screw-in Pipe Conn. (P50/94DK)    |
| 58                   | 2                    | 07.2947               | Rohrbogen (P50/94DK)              | Elbow for Rinsing Pipe (P50/94DK) |
|                      | 1                    | 00.5043               | Antrieb kpl. (P50/94D)            | Crankcase Assy P50/94D            |
|                      |                      |                       | (1-29A/30-33/49-49B/52/53)        | (1-29A/30-33/49-49B /52/53)       |
|                      | 1                    | 00.5044               | Antrieb kpl. (P50/94DK)           | Crankcase Assy (P50/94DK)         |
|                      |                      |                       | (1-29A/30-33/49-49B/52/53)        | (1-29A/30-33/49-49B /52/53)       |
|                      | 1                    | 00.5041               | Plungerwechselsatz (P50/94D)      | Plunger Replacement Kit           |
|                      |                      |                       | (29B-29D/35-42)                   | (29B-29D/35-42)                   |
|                      | 1                    | 00.5042               | Plungerwechselsatz (P50/94DK)     | Plunger Replacement Kit           |
|                      |                      |                       | (29B-29D/35-42/56-58)             | (29B-29D/35-42/56-58)             |
|                      | 1                    | 00.0850               | Pumpenkopf kpl. (P50/94D-DK)      | Pumphead Assy                     |
|                      |                      |                       | (43-48/50/50A)                    | (43-48/50/50A)                    |
|                      | 6                    | 00.1868               | Ventil kpl. (46A-46D)             | Valve Assy (46A-46D)              |
| •                    | 1                    | 14.0411               | Rep. Satz Dichtungen              | Seal Repair Kit                   |
| ••                   | 1                    | 14.0344               | Rep. Satz Ventile                 | Valve Repair Kit                  |

Bei Bestellung von Ersatzteilen bitte Bestell-Nr., Pumpen-Nr. und -type angeben.  
 When ordering please state Code No., Pump Model and Pump Serial No.

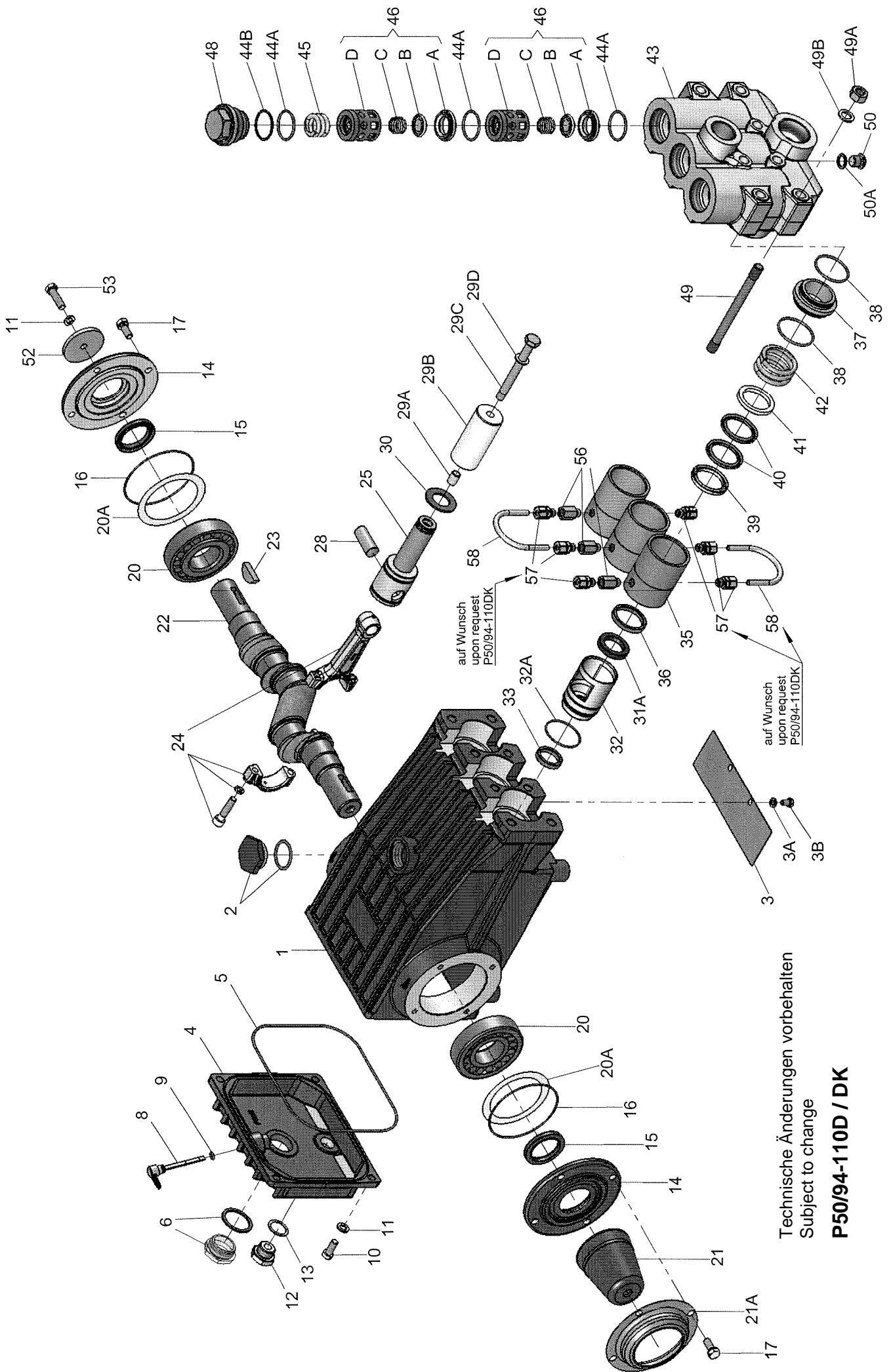

Technische Änderungen vorbehalten  
 Subject to change

**P50/94-110D / DK**